

Help Topics – Selecting a Topic

Catalog Home Page - Selecting a Component	1
Functional Elements in the Upper Area	2
Left-Hand Edge of the Screen: Elements for Navigating and Searching	3
Display and Zoom Functions for the Drawings	4
Shopping Basket – Adding Components and Defining the Transaction	5
Transaction Request	6
Transaction Order and sending the Shopping Basket	7

Catalog Home Page - Selecting a Component



Topics

The main components are displayed with a photo, year of manufacture, type code and serial number.

Click on a small photo or on the arrow keys to navigate between the main components.

Click on the large photo, to display the components of the machine or equipment

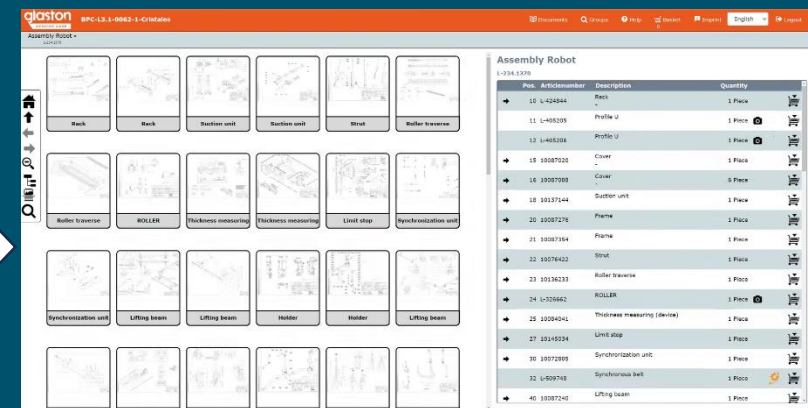
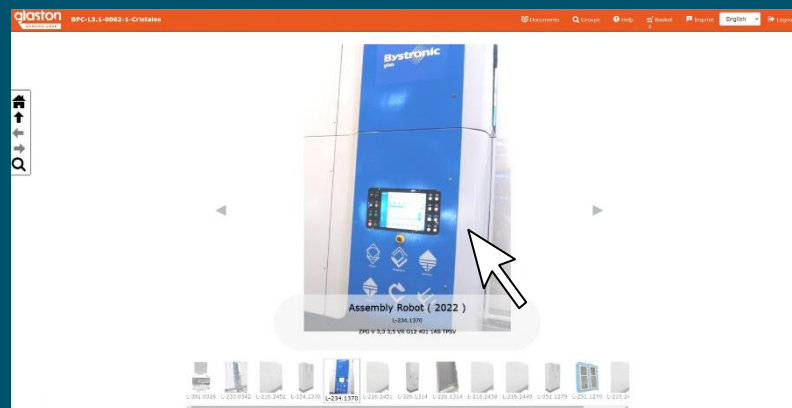

Functional Elements in the Upper Area

Topics

Product groups:
Find components
based on their function
or their shape

Documents:
Operating instructions
and wiring diagrams
in PDF- format

W1:
Find components
with average wear

W2:
Find components
with high wear

Basket:
Inquire about prices
here or send orders
directly

The screenshot shows the upper part of the Glaston Parts Catalog website. The navigation bar is orange and contains links for Documents, Groups, Help, Basket (0 items), Imprint, a language dropdown set to English, and a Logout button. Below the navigation bar, the main content area displays a product list for 'Assembly Robot' (L-234.1370). The list includes a table with columns for Position, Article Number, Description, and Quantity, along with icons for each item.

Pos.	Articlenumber	Description	Quantity
10	L-424844	Rack	1 Piece
11	L-405205	Profile U	1 Piece
12	L-405206	Profile U	1 Piece
15	10087020	Cover	1 Piece
16	10087008	Cover	6 Piece

1

2

3

4

5

6

7

Left-Hand Edge of the Screen:
Elements for Navigating and Searching

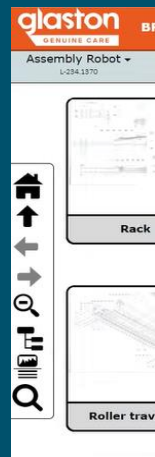

Jumps back to the home screen of the application



Opens the next higher level



Jumps to the previous assembly of the same level.



Jumps to the next assembly on the same level



Resets a magnified drawing to its original size



Shows or hides the assembly structures



Switches between 3 display types for drawing and component list



Search function: Enables searching by part number or by component name

Display and Zoom Functions for the Drawings

Move the cursor to an item number on the drawing to select the component in the list.

Click on the item number to display more information about the component.

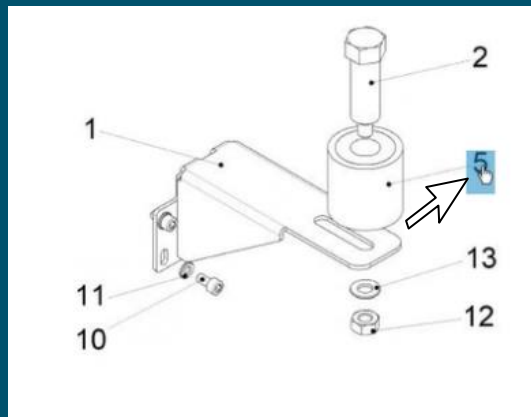

Click outside an item number to enlarge the display.

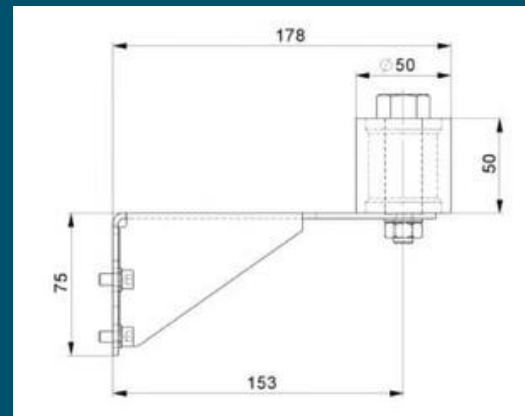

1

2

3

4

5

6

7

Shopping Basket – Adding Components and Defining the Transaction



To add a component to the shopping basket:
Click on the component or on the symbol
«**Add to basket**».

⇒ The «**Part information**» window appears.

Click on «**Add to my basket**».

⇒ The content of the shopping basket is shown.

Click on «**Continue**». In the next window, you can define the transaction type: request (offer) or order as well as the delivery date (express or normal).
If you do not want a partial delivery (Accept incomplete delivery), remove the checkmark.

Part information

Article Number:	L-306731
Designation:	Roller
Specification:	
Wearing Category:	W2
Used in Catalog:	362 pcs show usage
Used in Machine:	79 pcs show usage
Quantity:	1 pcs

[Click on image to enlarge](#)

[Add to my basket](#) [Cancel](#)

Basket

Your current basket:

Part Number	Designation	Quantity
L-326660	Plurum	1 pcs
L-306731	Roller	1 pcs

[Continue](#) [Print](#) [Clear Basket](#)



Order Header

Dealer-ID:

Customer-ID: Name:

Order-ID: Order-Date:

Your reference number:

Requested delivery date:

☒ Accept incomplete deliveries

Type:

Your inquiry is being handled by
ADMIN-Hamberg
Karl-Lenhardt-Str. 1-9
DE 75242 Neuhausen-Hamberg

1

2

3

4

5

6

7

Transaction Request



Topics

To create the request, proceed as follows:

In the «**Shopping Basket**» menu, select the «**Type**» dropdown menu and then the menu item “Request”.

Scroll down to display the «**Submit transaction**» button. Click on «**Submit transaction**».

⇒ The message «**Order XXX has been saved**» appears.

⇒ Click on «**Show Order**» to display an overview of the request.

Basket

Type: Request

Your inquiry is being handled by:
ADMIN-Hamburg
Karl-Lenhardt-Str. 1-9
DE 75242 Neuhausen-Hamburg

Pos	Partnumber	Designation	Quantity
10	L-326660	Fixture	1
20	L-306731	Roller	1
21			1
22			1
23			1
24			1
25			1
26			1
27			1
28			1
29			1
30			1

Submit Transaction More Lines



Basket

Order 00006944 has been saved

Show Order

Print E-mail

Glaston Parts Catalog – Global

Request

From: Sent by:

Catalog no.:
BPC processing no.: 00006957
Date and time: 26.07.2023 11:22:16

ARCHITECTURAL GLASS

We wish to order the following items subject to the published conditions of delivery:

Part No.	Designation	Quantity	Unit	Illustration	Reference
L-326660	Fixture	1	Piece		L-234.1370
L-306731	Roller	1	Piece		L-234.1370

Preferred delivery date: as soon as possible/express

Accepted form of delivery: complete delivery or partial delivery

Your purchase order will be processed by:

1

2

3

4

5

6

7

Transaction Order and sending the Shopping Basket



Topics

Scroll down to display the «**Submit transaction**» button. Click on «**Submit transaction**».

⇒ The message «**Order XXX has been saved**» appears.

Click on «**Show Order**» to display an overview of the order.

1

2

3

4

5

6

7

Basket

Time: Order

Your inquiry is being handled by:
ADMIN-Hamberg
Karl-Lenhardt-Str. 1-9
DE 75242 Neuhausen-Hamberg

Pos	Partnumber	Designation	Quantity
10	L-326660	Fixture	1
20	L-306731	Roller	1
21			1
22			1
23			1
24			1
25			1
26			1
27	T		1
28			1
29			1
30			1

Submit Transaction More Lines



Basket

Order 00006944 has been saved

Show Order

Order

From: Sent by:

Catalog no.: 00006957
BPC processing no.: 00006957
Date and time: 26.07.2023 11:22:16

We wish to order the following items subject to the published conditions of delivery:

Part No.	Designation	Quantity	Unit	Illustration	Reference
L-326660	Fixture	1	Piece		L-234.1370
L-306731	Roller	1	Piece		L-234.1370

Preferred delivery date: as soon as possible/express
Accepted form of delivery: complete delivery or partial delivery
Your purchase order will be processed by:



1

2

3

4

5

6

7

Should you still experience any problems, contact your nearest service partner or:

documentation.de@glaston.net
(Glaston Germany GmbH – Germany)